

Submersible Dewatering Pump

The Liberator range of submersible drainage pumps are compact light and powerful. They are suitable for groundwater and water containing sand and silt. They have a maximum solids handling of 7mm.

Features:

- Compact lightweight design
- High abrasive resistance resin Vortex impeller
- Double mechanical seal

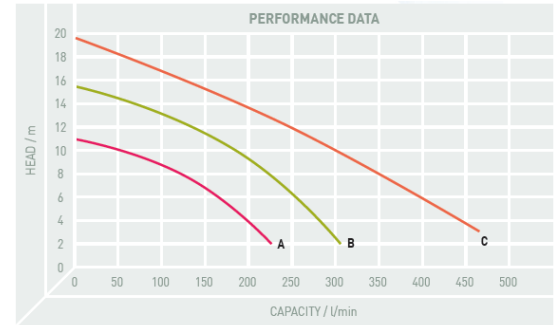

TECHNICAL SPECIFICATION

PUMP TYPE	PRODUCT CODE	CURVE	OUTPUT		DISCHARGE		RATED		MAXIMUM		FREE PASSAGE mm	CABLE	WEIGHT kg
			AMP	kW	mm	inch	HEAD M	CAPACITY LPM	HEAD M	CAPACITY LPM			
LIB400 110V*	PH/LIB400/110V	A	6	0.4	50	2	8	120	11	225	7	10	13
LIB400 230V*	PH/LIB400/230V	A	3	0.4	50	2	8	120	11	225	7	10	13
LIB400 400V	PH/LIB400/400V	A	0.9	0.4	50	2	8	120	11	225	7	10	13
LIB750 110V*	PH/LIB750/110V	B	11	0.75	50	2	10	190	15.3	300	7	10	16
LIB750 230V*	PH/LIB750/230V	B	5.4	0.75	50	2	10	190	15.3	300	7	10	16
LIB750 400V	PH/LIB750/400V	B	1.9	0.75	50	2	10	190	15.3	300	7	10	16
LIB1500 110V	PH/LIB1500/110V	C	26	1.5	50/80	2/3	10	300	19.7	460	7	10	24
LIB1500 230V	PH/LIB1500/230V	C	12	1.5	50/80	2/3	10	300	19.7	460	7	10	26
LIB1500 400V	PH/LIB1500/400V	C	4	1.5	50/80	2/3	10	300	19.7	460	7	10	24

*Automatic versions available on request

PARTS AND MATERIAL LISTS

PARTS & MATERIAL LIST		
NUMBER	PART	MATERIAL
1	HANDLE	STEEL
2	MOTOR COVER	ADC12
3	BRACKET	STEEL
4	MOTOR HOUSING & STATOR	ADC12
5	SHAFT WITH ROTOR	SUS 410
6	OIL CHAMBER	ADC12
7	MECHANICAL SEAL	CA / CE & SIC / SIC
8	IMPELLER	HYTREL
9	PUMP CASING	FC 20
10	UPPER BEARING	
11	LOWER BEARING	
12	STRAINER	SUS304 / *NBR
13	VOLUTE LINER	NBR
14	OUTER COVER	SUS 304

LIBERATOR® 400/750 PARTS

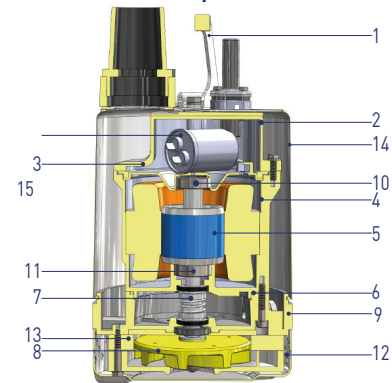

LIBERATOR® 1500 PARTS

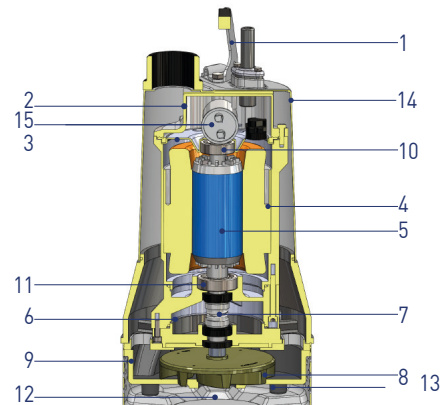

DIMENSIONAL DRAWINGS

LIBERATOR® 400/750

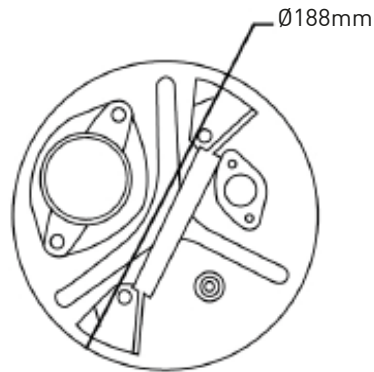
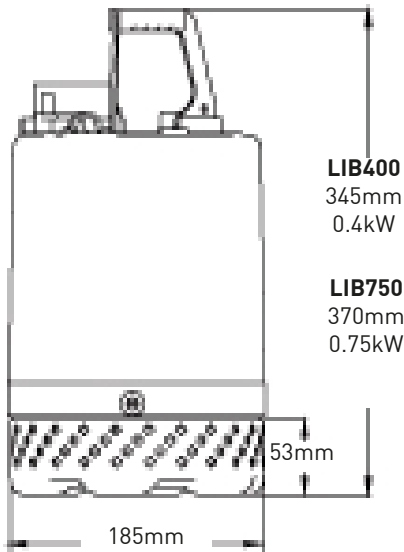

LIBERATOR® 1500

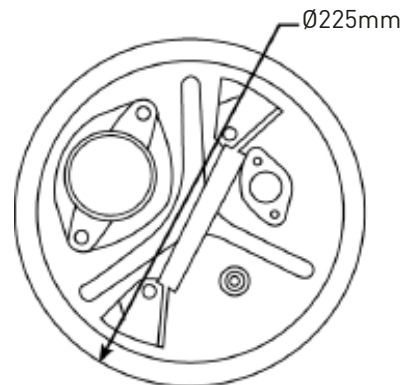
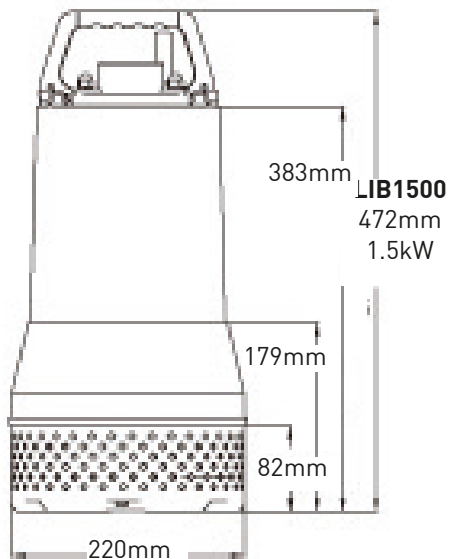

Why not try our pump Conversion Kit?

Unique inter-changeable design, allowing the Liberator 400/750 to be converted to a PuddlePal and vice-versa.



How to Videos

Check out our how to video at
www.ttpumps.com/how-to
to find out more!